

**ELEVATION VIEW**

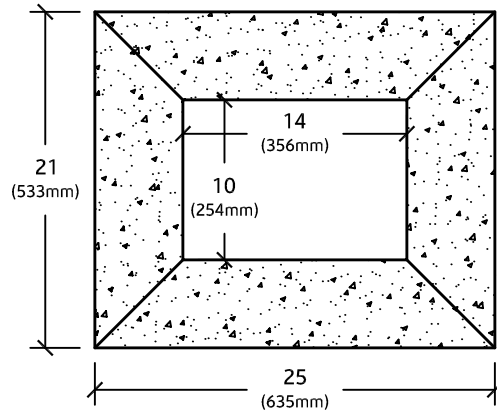

**PLAN VIEW**

**NOTES:**

1. CONTRACTOR TO REFER TO ARCHITECTURAL SPECIFICATIONS FOR COLOUR, FINISH AND VALUE ADDED FEATURE.
2. ALL UNITS COME REINFORCED WITH 10M REBAR.



**PRECAST CHIMNEY CAPS**

**WSSC2-2.5**

ED'S CONCRETE PRODUCTS  
 1266 ERIE STREET  
 STRATFORD, ONTARIO  
 N4Z 0A1

1-877-265-6590  
[www.edskoncrete.com](http://www.edskoncrete.com)  
[info@edskoncrete.com](mailto:info@edskoncrete.com)

